

ARFX5 Addressable Radio Frequency Receiver

The Guardian **ARFX5** is an addressable RF receiver unit housed within a metal IP65 rated weatherproof enclosure, designed specifically to provide coverage for external areas such as patios and gardens, or to provide back up for the infra red receivers inside a building. The installation and operation of this unit is similar to that of the AIRX3 External IR Unit. The RF range can be affected by many factors including the weather and local conditions (e.g. location of buildings, large metal objects, cars, vans, chain link fences etc) and it is strongly recommended that a site survey is done to ascertain the correct number and locations of ARFX5 units required.

Primary Mode: Primary mode is used when the radio receiver is out of range of any infra red receivers, or when there are no infra red receivers used on the system. Any radio receiver located on an out building or mast in a car park which is away from the main building should be set to primary mode. Units which are set to secondary mode will take typically 8 – 10 seconds to activate.

Secondary Mode: Secondary mode is used when the radio receiver is within range of the infra red receivers, or when the radio receiver is intended as a back up to the infra red system. Any incident that triggers an infra red receiver will not activate an ARFX5 in secondary mode – ensuring that the correct location is shown on the DISP1 LCD Display. Any incident that is not picked up by the infra red receivers will be picked up by the radio receiver which will then initiate the alarm. If the same incident is subsequently picked up by the infra red receivers they will then take over from the radio receiver location.

In the event of tampering with the ARFX5, the unit has a tamper switch built into it, which will alert the LCD Display units. As with the AIRX4, the unit is addressed by the use of DIL switches. In addition there is a removable jumper inside to disable the tamper switch. When mounting externally it is important to mount the unit in a vertical orientation with the cable gland at the bottom and the aerial at the top. Always keep network cabling away from the top of the box, even when passing through a wall to enter the enclosure from behind.

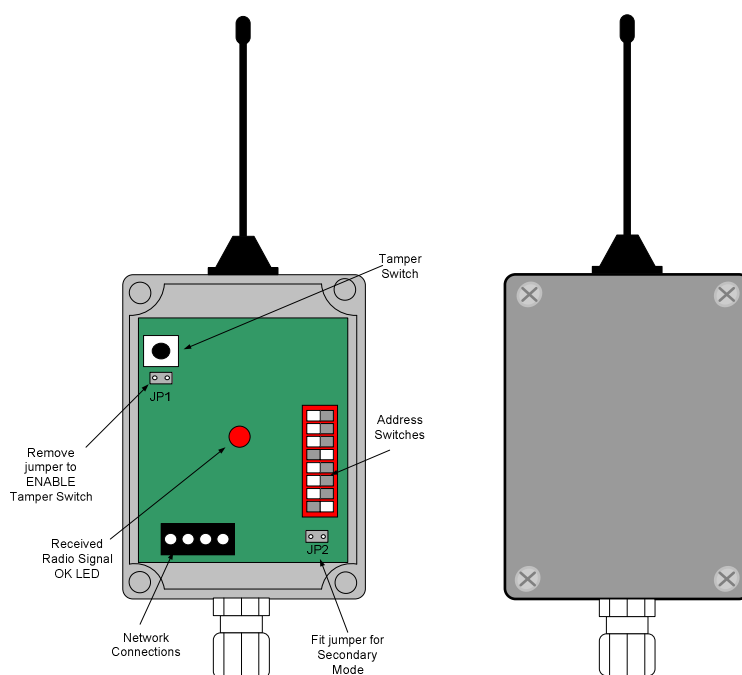

- Red Test LED - Flashes once when valid RF signal is received. (does not latch)
- Address Switches - Used to set the address for each unit (between 1 & 215)
N.B. Each unit MUST have a UNIQUE address
- Tamper Jumper - Remove this jumper to enable the Tamper Switch. Fit to disable Tamper
- + & - terminals - Used to connect the receiver unit to the system network. **(Observe Polarity)**
- Distance between - Minimum of 100m apart in open space (outside). Always site test before deciding on units distance apart inside. Never locate unit beneath the ground.

Site Survey: Always carry out a site survey with an STC6 IR/RF Personal Activation Device before committing to the number and location of ARFX5 RF Receiver Units. There is a red LED fitted to the p.c.b of the ARFX5 which flashes once when the radio code is received. This will occur whether the unit is connected to a 12v battery or the Guardian system network.